

P:\PE\A-Z\City of Cumming 2024-0124 Cumming-PWPF Phase 2 Clearwell Improvements_3 ENGINEERING Drawings\C-102 DEMOLITION SITE PLAN - 2024-0124.dwg Thu, 06/11/26 10:54 AM

LEGEND

LINEAR ITEM TO BE DEMOLISHED/REMOVED - - - - -

ITEM TO BE DEMOLISHED/REMOVED X

AREA OF BUILDING OR PAVEMENT TO BE DEMOLISHED [Hatched Box]

NOTES:

- CONTRACTOR TO CLEAR AND GRUB AND REMOVE ALL TREES WITHIN THE LIMITS OF DISTURBANCE OF THE SITE.

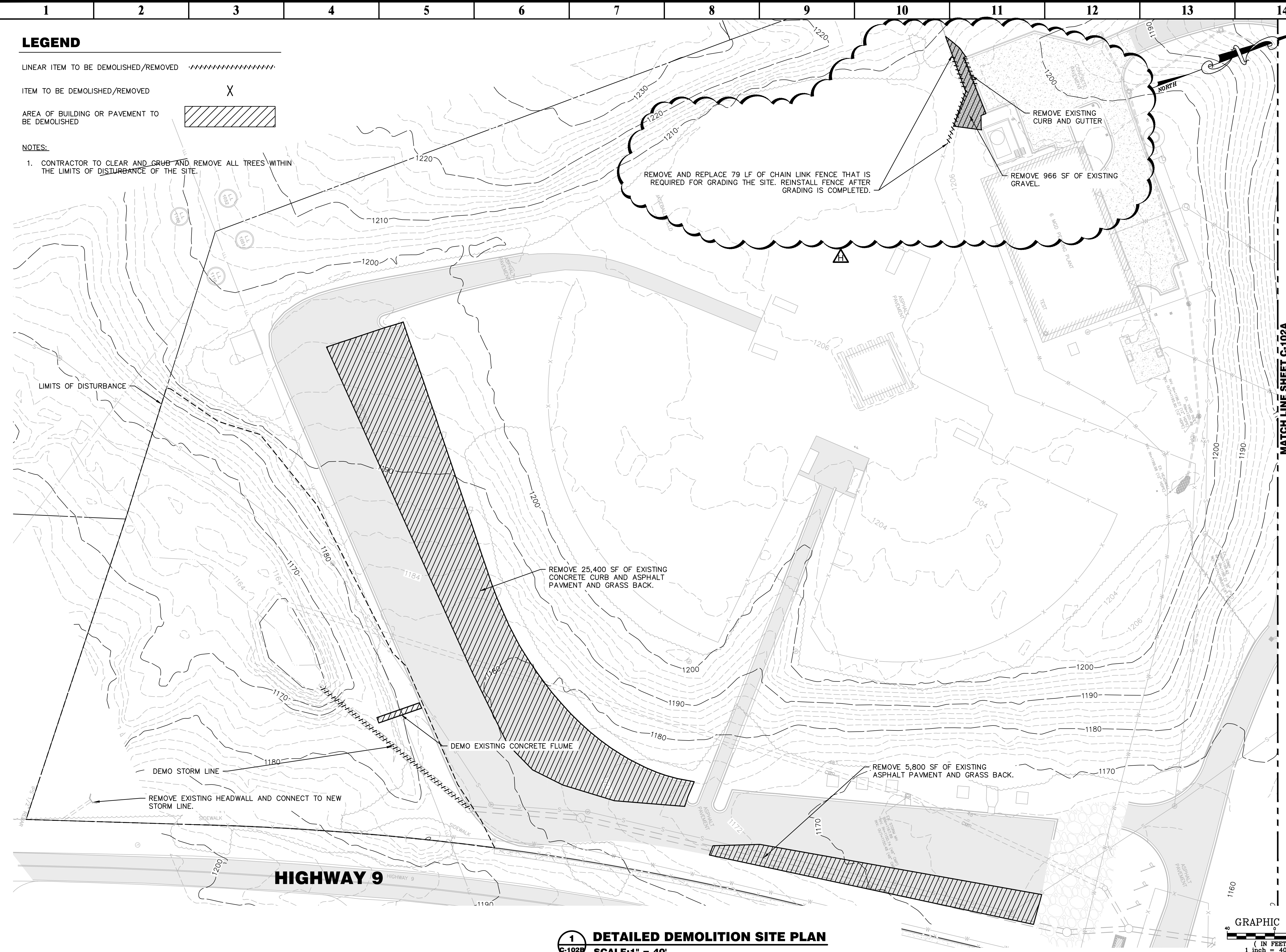

1 DETAILED DEMOLITION SITE PLAN
 C-102B SCALE: 1" = 40'

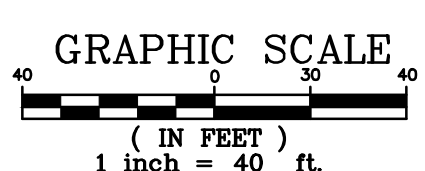

PRIME
 A Stratus Team Company
 3715 NORTHSIDE PARKWAY NW
 300 NORTH CREEK SUITE 200
 ATLANTA, GEORGIA 30327
 404.425.7100

PROJECT: **PWPF PHASE 2 CLEARWELL IMPROVEMENTS**
 PREPARED FOR: **CITY OF CUMMING**

NO.	DATE	DESCRIPTION
A	10/11/24	ISSUED FOR 30% REVIEW
B	12/17/24	30% REVIEW RESUBMIT
C	01/29/25	ISSUED FOR 60% REVIEW
D	05/13/25	ISSUED FOR 60% REVIEW
E	02/06/26	ISSUED FOR 90% REVIEW
F	04/03/26	ISSUED FOR 100% REVIEW
G	04/21/26	ISSUED FOR BID
H	06/12/26	ADDENDUM 2

SEAL

 DATE: 06/12/2026

© 2025 PRIME ENGINEERING, INC. Scales, as stated herein, are valid on the original drawing; the dimensions of which are 22 by 34 inches. These scales, noted herein, are hereby changed by the ratio of the overall sheet dimensions of the print to corresponding dimensions of the original drawing. This drawing is the property of PRIME ENGINEERING, INCORPORATED and is not to be reproduced or copied in whole or in part. It is only to be used for the project and is not to be used on any other project. It is to be returned upon request.

DRAWING TITLE
DETAILED DEMOLITION SITE PLAN

DRAWING DATE	04/17/2026
DRAWN BY	KLK
DESIGNED BY	KLK
CHECKED BY	RRM
PROJECT NUMBER	2024-0124
DRAWING NUMBER	C-102B

ISSUED FOR CONSTRUCTION